

# APPENDIX

**P**

PRELIMINARY  
ROAD DESIGN



## APPENDIX

***P-3***

***EAST-WEST  
ARTERIAL  
DRAWNINGS***



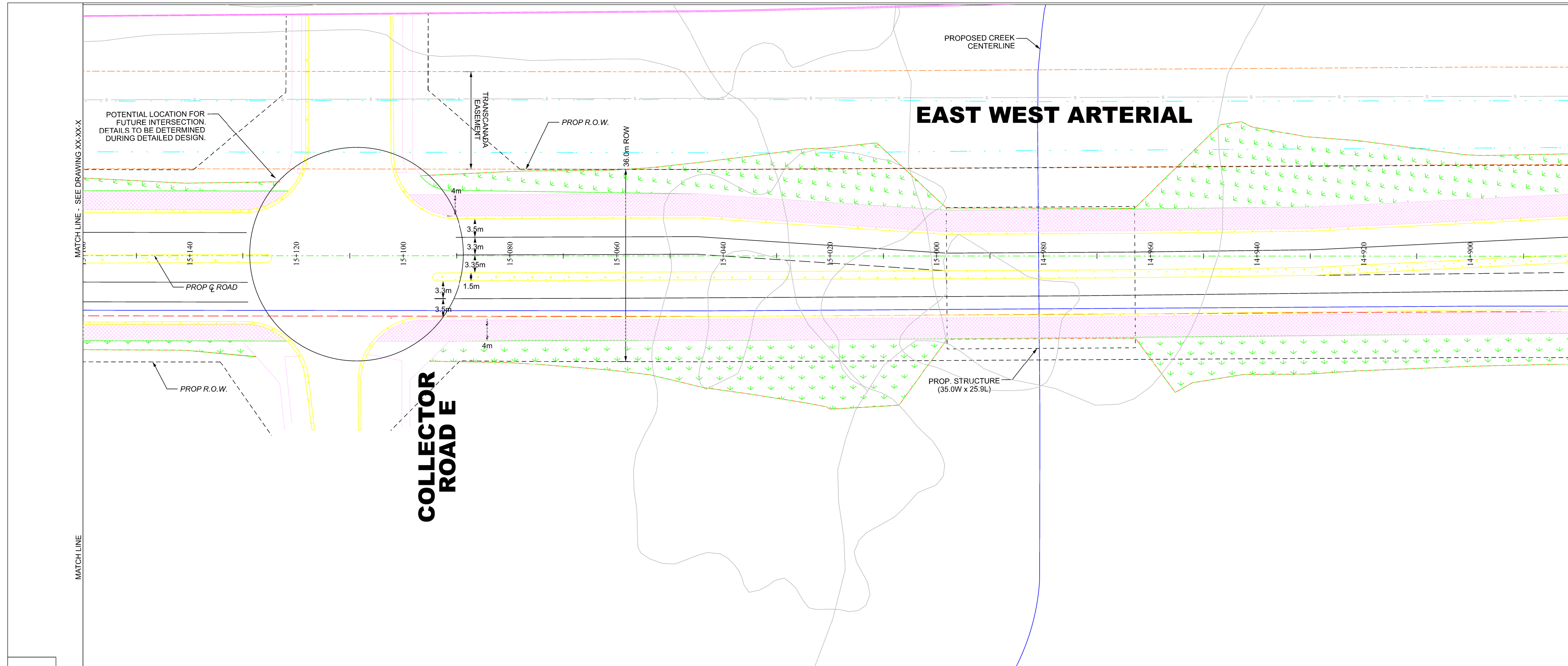

**FOR STORM AND ROADWORKS ONLY**

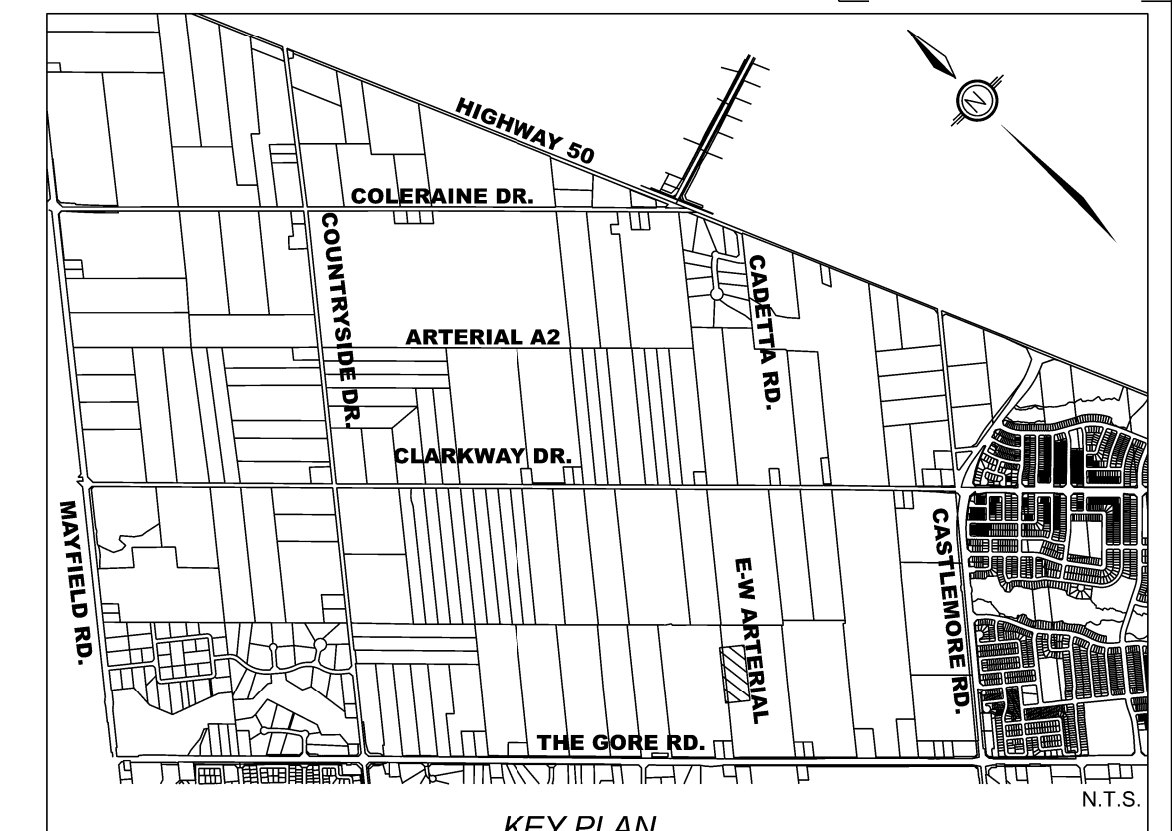

**LEGEND:**

PROP CONC BUS BAY	PROP IMPRESSED COLOURED CONC
PROP CONC KILLSTRIP/MEDIAN	PROP ASPH MULTI USE TRAIL
PROP ASPHALT PAVEMENT	PROP DW RELOCATED / NEW
PROP DW REINSTATEMENT	PROP TEMP ASPH PEDESTRIAN CONNECTION
PROP STORM SEWER (PROFILE ONLY)	PROP SILT FENCE (TREE HOARDING)
PROP MILLING & PLACEMENT OF 40mm HLT	PROP LIMIT OF GRADING
PROP CONC SIDEWALK / BUS PAD	PROP TEMP ROCK CHECK DAM [DPSD 219.210]
PROP TACTILE WALKING STRIP INDICATOR	EX OVERHEAD HYDRO
EX SANITARY SEWER	EX BELL
EX WATERMAIN	PROP OVERHEAD HYDRO
EX GAS	PROP UNDERGROUND HYDRO
PROP WATERMAIN	PROP STORM SEWER
PROP SANITARY SEWER	

- NOTES:**
- ALL EXIST MH TOPS, GAS, WATER & OTHER APPURTENANCES TO BE ADJUSTED TO SUIT PROP GRADES
  - DCB & D/CB LEADS TO BE 200mm, CB LEADS TO BE 200mm UNLESS OTHERWISE NOTED
  - ALL EXISTING CURBS WITHIN R.O.W. TO BE REMOVED UNLESS OTHERWISE NOTED
  - PROPOSED MEDIANS TO HAVE CONCRETE BARRIER CURB O.P.S.D. 800.080
  - PROPOSED CONCRETE KILLSTRIP / MEDIAN SHALL BE DESIGNED TO 150mm CONCRETE 32MPa 200mm OF 20mm CRUSHER RUN LIMESTONE
  - ALL EXISTING UTILITY LOCATIONS ARE APPROXIMATE AND ARE TO BE CONFIRMED IN THE FIELD PRIOR TO CONSTRUCTION
  - FOR FINAL LAYOUT APPROVAL OF TRANSIT PADS PRIOR TO INSTALLATION, PLEASE CONTACT DAVID STOWE AT (905) 874-2750 EXT 62378 OR CHRIS LAFLEUR EXT 62620
  - CITY REFERS TO THE CITY OF BRAMPTON
  - SEE DRAWINGS - - - FOR DIMENSIONS
  - SEE DRAWINGS - - - FOR REMOVALS
  - SEE DRAWING - - - FOR TYPICAL CROSS SECTIONS
  - SEE DRAWINGS - - - FOR PAVEMENT ELEVATION DETAILS
  - SEE DRAWINGS - - - FOR PAVEMENT MARKINGS AND SIGNAGE
  - SEE DRAWINGS - - - FOR LANDSCAPING DRAWINGS
  - SEE DRAWINGS - - - FOR STRUCTURAL DRAWINGS
- REFERENCE:** BENCH MARK F2-581 240.393m  
One story brick building, no 45 Regan Road. Table is set in the southeast face of concrete foundation, 3.25m northeasterly of the southerly building corner and 0.15m above the sidewalk.

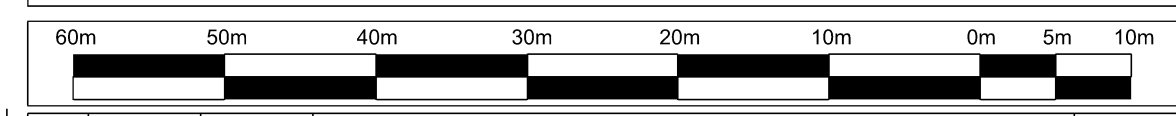

NO.	BY	DATE	REVISIONS	CHECKED
01	M.K.	15NOV19	ISSUED FOR 30% REVIEW	M.K.

**BRAMPTON** Region of Peel  
Flower City working with you

**wood.**

**Public Works & Engineering**  
**Capital Works**

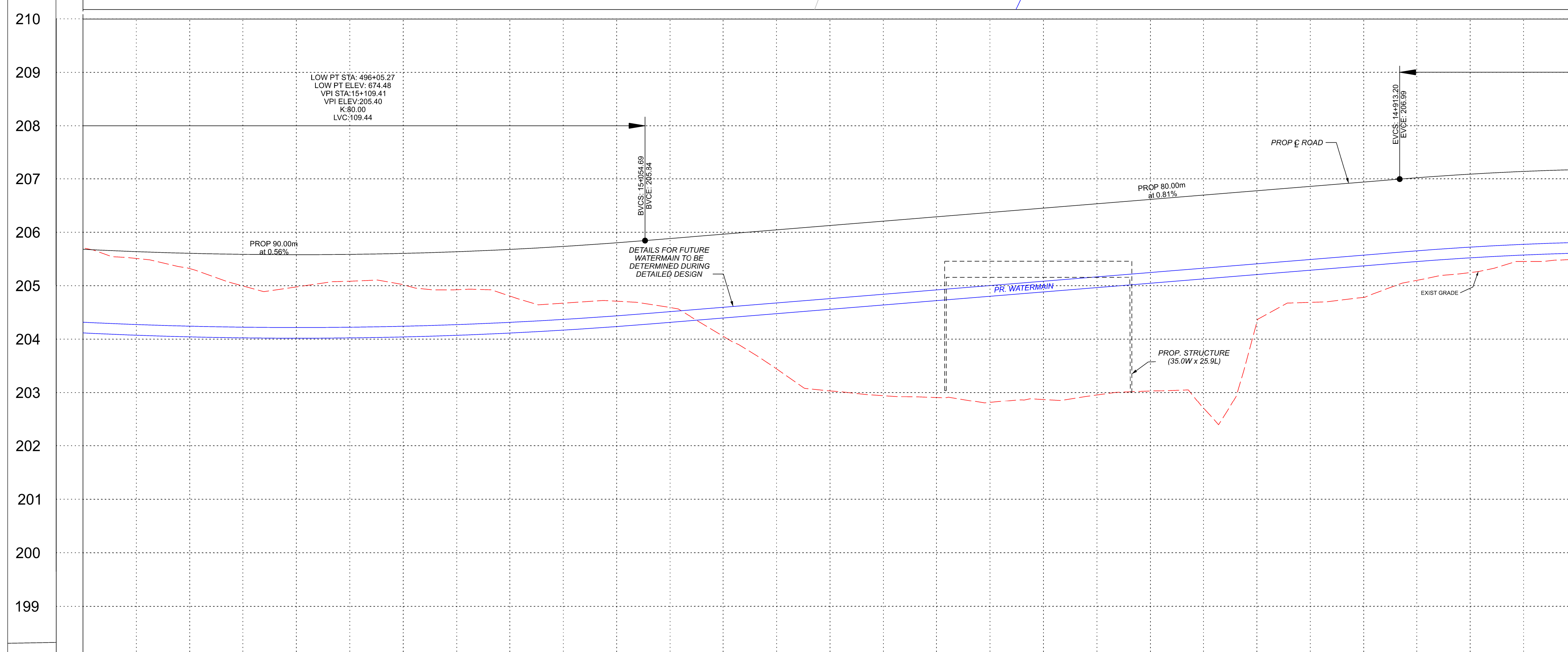

STORM INVERT	SANITARY INVERT	PROPOSED GRADES	CENTERLINE CHAINAGE	STORM INVERT	SANITARY INVERT	PROPOSED GRADES	CENTERLINE CHAINAGE
		205.88	15+190			207.17	14+880
		205.61	15+140			207.09	14+900
		205.58	15+120				
		205.60	15+100				
		205.68	15+080				
		205.80	15+060				
		205.96	15+040				
		206.13	15+020				
		206.29	15+000				
		206.45	14+980				
		206.61	14+960				
		206.78	14+940				
		206.94	14+920				
		207.09	14+900				

**EAST WEST**  
STA. 15+160 TO STA. 14+880

Description

**PROPOSED RECONSTRUCTION**

SURVEYED BY: BRAMPTON	DATE: NOVEMBER 15, 2019	FILE NO.	xxxxxx
DRAWN BY: A. KARAMBAKSHIAN	CHECKED BY: M. KHAN	DRAWING NO.	
DESIGNED BY: M. KHAN	CHECKED BY: M. KHAN		
SCALE: v 1:50 h 1:500	DATE: 15 NOV 19		<b>XX-XX-XX</b>

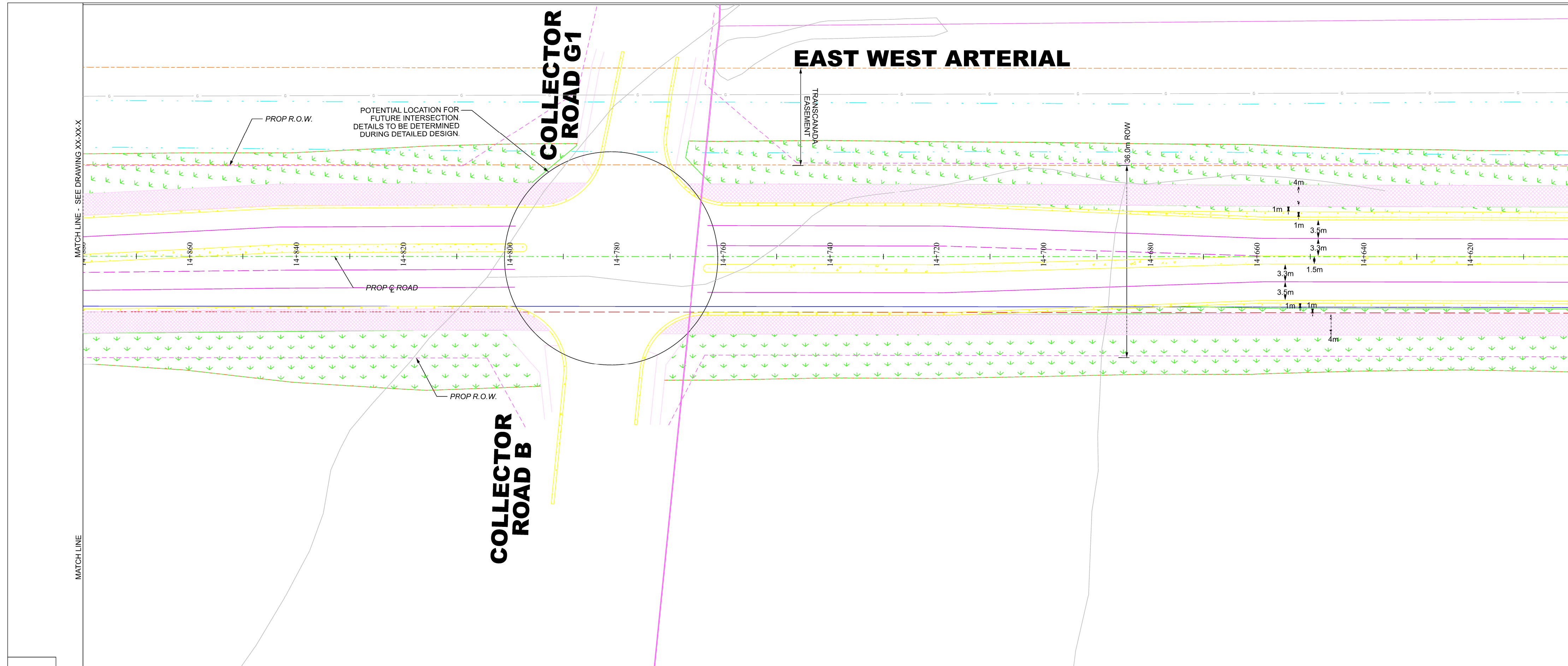

**FOR STORM AND ROADWORKS ONLY**

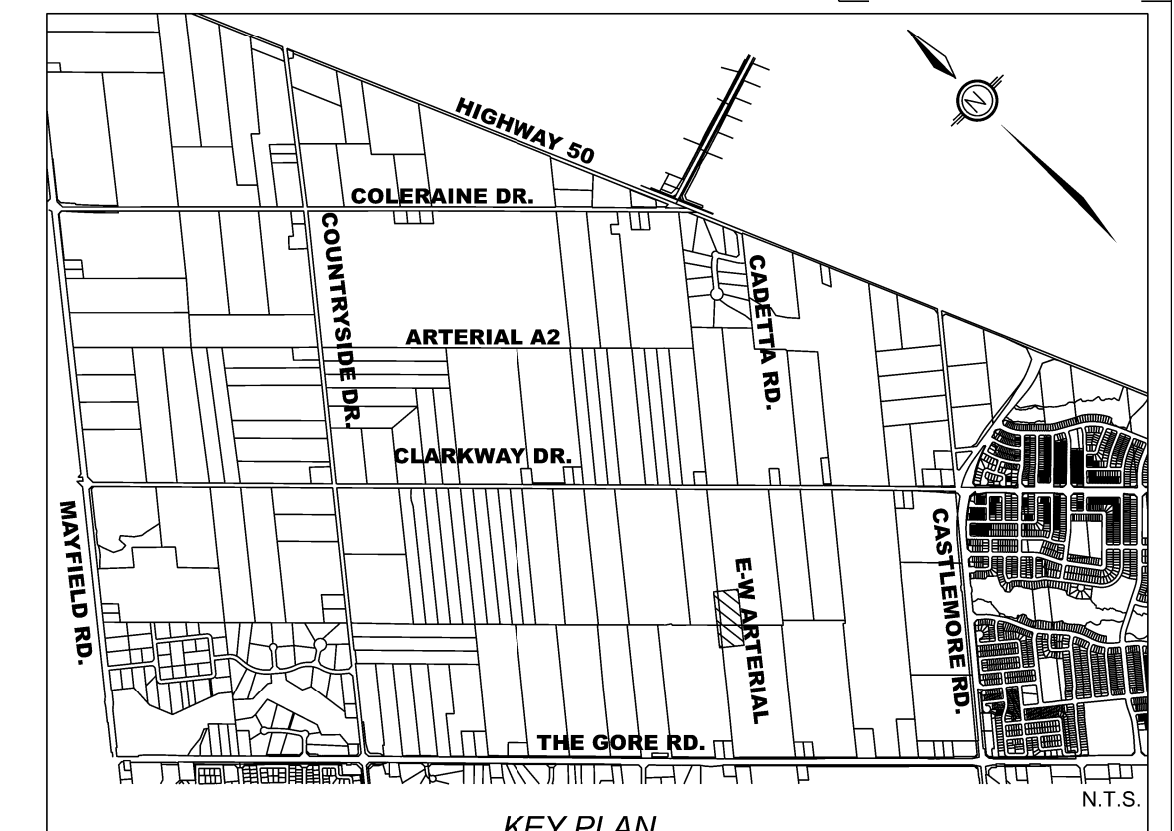

**LEGEND:**

PROP CONC BUS BAY	PROP SEED / SOD
PROP CONC KILLS/STRIP/MEDIAN	PROP IMPRESSED COLOURED CONC
PROP ASPHALT PAVEMENT	PROP ASPH MULTI USE TRAIL
PROP DW REINSTATEMENT	PROP DW RELOCATED / NEW
PROP STORM SEWER (PROFILE ONLY)	PROP TEMP ASPH PEDESTRIAN CONNECTION
PROP MILLING & PLACEMENT OF 40mm HLT	PROP SILT FENCE (TREE HOARDING)
PROP CONC SIDEWALK / BUS PAD	PROP LIMIT OF GRADING
PROP TACTILE WALKING STRIP INDICATOR	PROP TEMP ROCK CHECK DAM (RPSD 219.210)
EX SANITARY SEWER	EX OVERHEAD HYDRO
EX WATERMAIN	EX BELL
EX GAS	PROP OVERHEAD HYDRO
PROP WATERMAIN	PROP UNDERGROUND HYDRO
PROP SANITARY SEWER	PROP STORM SEWER

- NOTES:**
- ALL EXIST MH TOPS, GAS, WATER & OTHER APPURTENANCES TO BE ADJUSTED TO SUIT PROP GRADES
  - DCB & DIB LEADS TO BE 200mm, CB LEADS TO BE 200mm, UNLESS OTHERWISE NOTED
  - ALL EXISTING CURBS WITHIN P.O.W. TO BE REMOVED UNLESS OTHERWISE NOTED
  - PROPOSED MEDIANS TO HAVE CONCRETE BARRIER CURB O.P.S.D. 800.080
  - PROPOSED CONCRETE KILLS/STRIP / MEDIAN SHALL BE DESIGNED TO 150mm CONCRETE 32MPa 200mm OF 20mm CRUSHER RUN LIMESTONE
  - ALL EXISTING UTILITY LOCATIONS ARE APPROXIMATE AND ARE TO BE CONFIRMED IN THE FIELD PRIOR TO CONSTRUCTION
  - FOR FINAL LAYOUT APPROVAL OF TRANSIT PADS PRIOR TO INSTALLATION, PLEASE CONTACT DAVID STOWE AT (905) 874-2750 EXT 62378 OR CHRIS LAFLEUR EXT 62620
  - CITY REFERS TO THE CITY OF BRAMPTON
  - SEE DRAWINGS - - - FOR DIMENSIONS
  - SEE DRAWINGS - - - FOR REMOVALS
  - SEE DRAWING - - - FOR TYPICAL CROSS SECTIONS
  - SEE DRAWINGS - - - FOR PAVEMENT ELEVATION DETAILS
  - SEE DRAWINGS - - - FOR PAVEMENT MARKINGS AND SIGNAGE
  - SEE DRAWINGS - - - FOR LANDSCAPING DRAWINGS
  - SEE DRAWINGS - - - FOR STRUCTURAL DRAWINGS
- REFERENCE:** BENCH MARK F2-581 240.393m  
One story brick building, no 43 Regan Road. Table is set in the southeast face of concrete foundation, 3.25m northeasterly of the southerly building corner and 0.15m above the sidewalk.

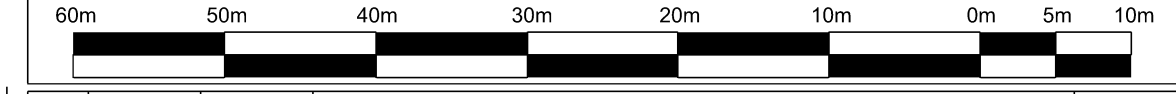

NO.	M.K.	DATE	REVISIONS	CHECKED
01	M.K.	15NOV19	ISSUED FOR 30% REVIEW	M.K.

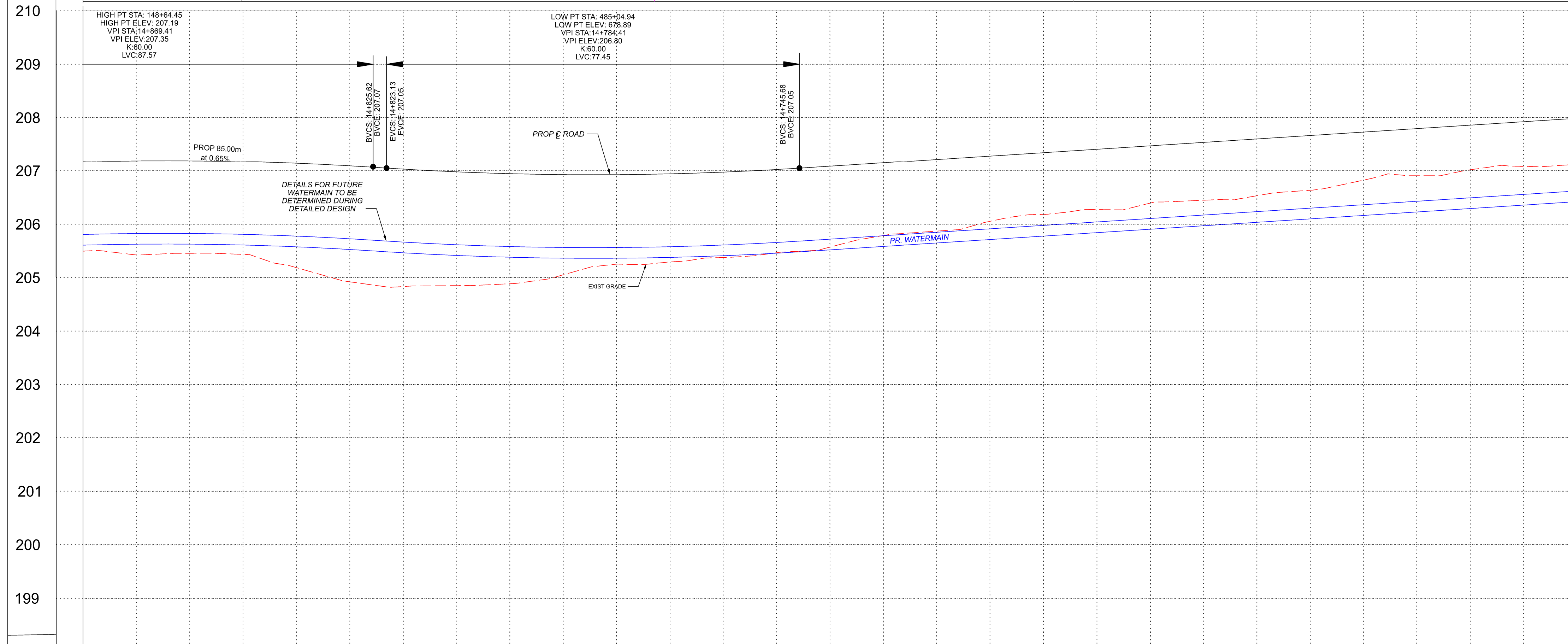

STORM INVERT	SANITARY INVERT	PROPOSED GRADES	CENTERLINE CHAINAGE
		14+880 207.17	14+880
		14+860 207.19	14+860
		14+840 207.14	14+840
		14+820 207.03	14+820
		14+800 206.95	14+800
		14+780 206.93	14+780
		14+760 206.97	14+760
		14+740 207.09	14+740
		14+720 207.21	14+720
		14+700 207.34	14+700
		14+680 207.47	14+680
		14+660 207.60	14+660
		14+640 207.73	14+640
		14+620 207.86	14+620
		14+600 207.99	14+600
STORM INVERT	SANITARY INVERT	PROPOSED GRADES	CENTERLINE CHAINAGE

**BRAMPTON** Flower City  
**Region of Peel** working with you  
**wood.**  
 Public Works & Engineering  
 Capital Works

**EAST WEST**  
 STA. 14+880 TO STA. 14+600  
 Description  
**PROPOSED RECONSTRUCTION**

SURVEYED BY: BRAMPTON	DATE: NOVEMBER 15, 2019	FILE NO.:	xxxxxx
DRAWN BY: A. KARAMBAKHSHAN	CHECKED BY: M. KHAN	DRAWING NO.:	SHEET NO.
DESIGNED BY: M. KHAN	CHECKED BY: M. KHAN	<b>XX-XX-XX</b>	
SCALE: v 1:50 h 1:500	DATE: 15 NOV 19		



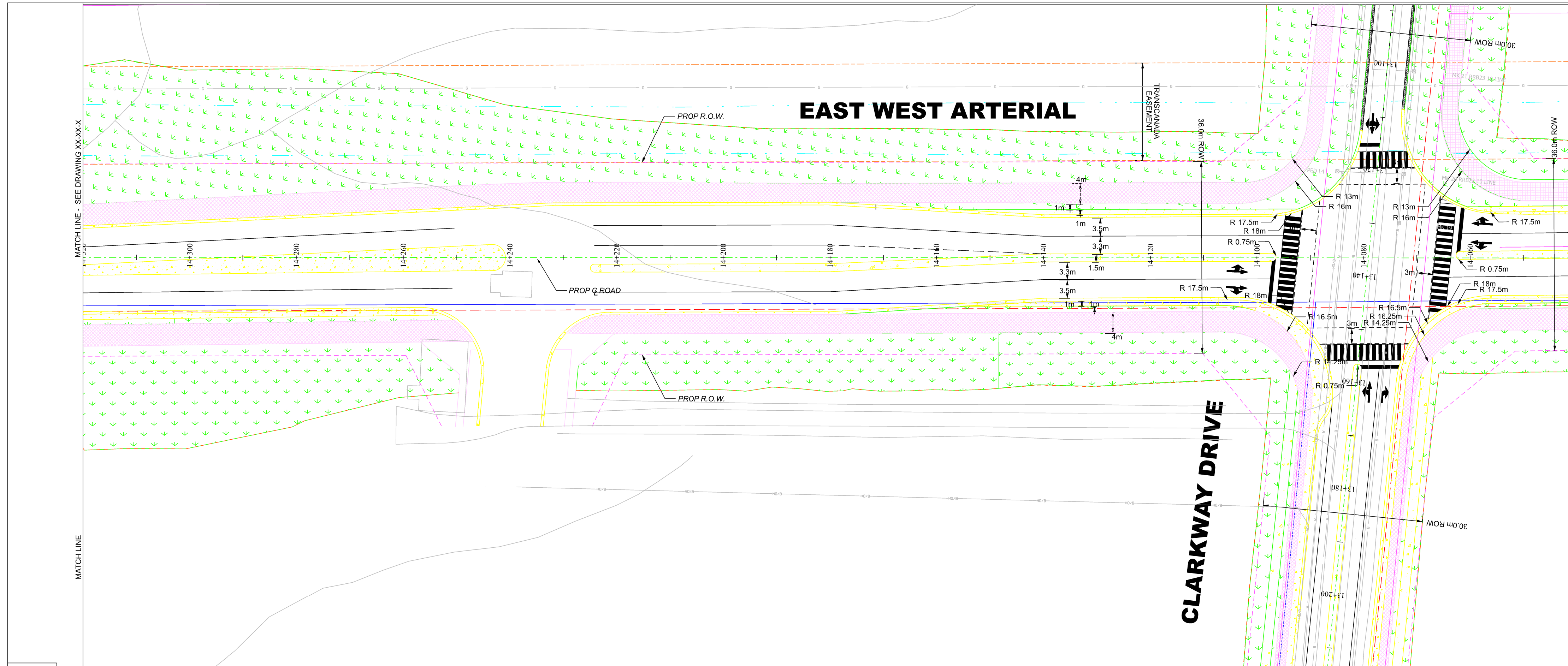

**FOR STORM AND ROADWORKS ONLY**

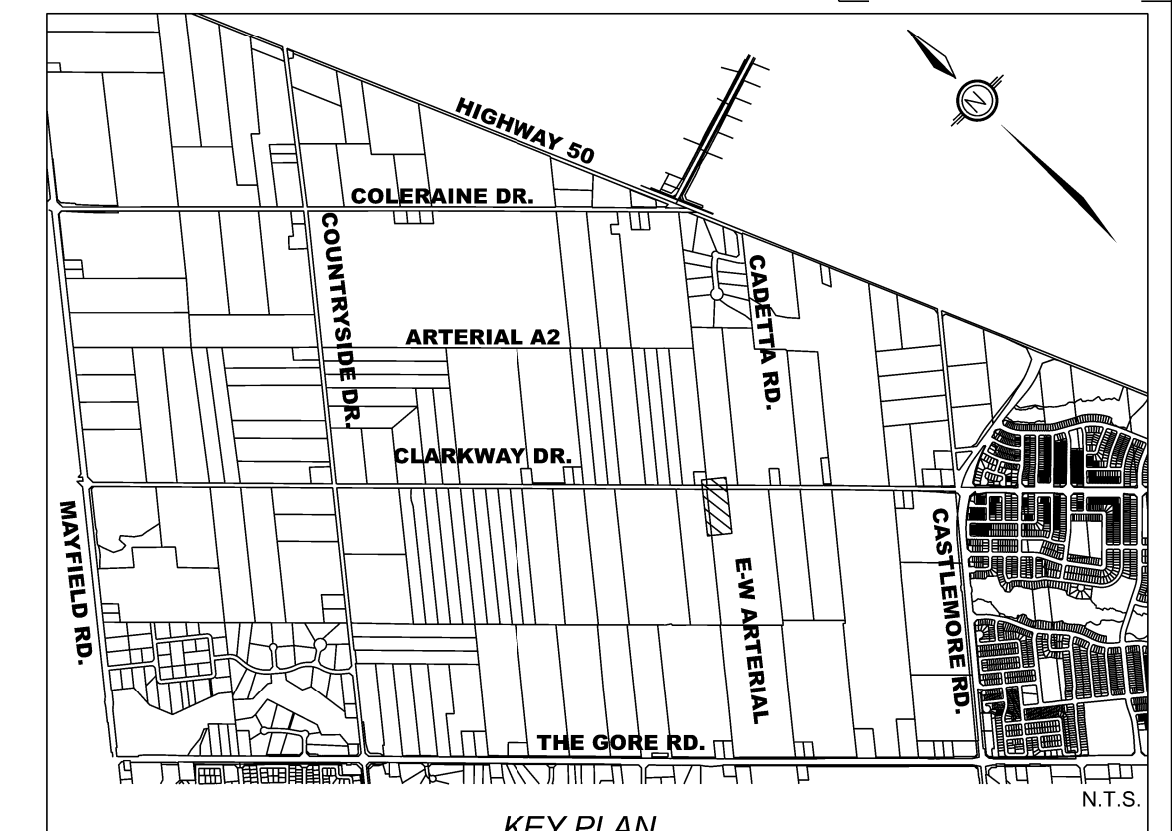

**LEGEND:**

PROPOSED CONC BUS BAY	PROPOSED IMPRESSED COLOURED CONC
PROPOSED CONC KILLSSTRIP/MEDIAN	PROPOSED ASPH MULTISE TRAIL
PROPOSED ASPHALT PAVEMENT	PROPOSED D/W RELOCATED / NEW
PROPOSED D/W REINSTATEMENT	PROPOSED TEMP ASPH PEDESTRIAN CONNECTION
PROPOSED STORM SEWER (PROFILE ONLY)	PROPOSED SILT FENCE (TREE HOARDING)
PROPOSED MILLING & PLACEMENT OF 40mm HLT	PROPOSED LIMIT OF GRADING
PROPOSED CONC SIDEWALK / BUS PAD	PROPOSED TEMP ROCK CHECK DAM (DPSD 219.210)
PROPOSED TACTILE WALKING STRIP INDICATOR	EXISTING OVERHEAD HYDRO
EXISTING SANITARY SEWER	EXISTING BELL
EXISTING WATERMAIN	PROPOSED OVERHEAD HYDRO
EXISTING GAS	PROPOSED UNDERGROUND HYDRO
PROPOSED WATERMAIN	PROPOSED STORM SEWER
PROPOSED SANITARY SEWER	

- NOTES:**
- ALL EXIST MH TOPS, GAS, WATER & OTHER APPURTENANCES TO BE ADJUSTED TO SUIT PROP GRADES
  - DCB & D/CB LEADS TO BE 200mm, CB LEADS TO BE 200mm, UNLESS OTHERWISE NOTED
  - ALL EXISTING CURBS WITHIN R.O.W. TO BE REMOVED UNLESS OTHERWISE NOTED
  - PROPOSED MEDIANS TO HAVE CONCRETE BARRIER CURB O.P.S.D. 600.080
  - PROPOSED CONCRETE KILLSSTRIP / MEDIAN SHALL BE DESIGNED TO 150mm CONCRETE 32MPa 200mm OF 20mm CRUSHER RUN LIMESTONE
  - ALL EXISTING UTILITY LOCATIONS ARE APPROXIMATE AND ARE TO BE CONFIRMED IN THE FIELD PRIOR TO CONSTRUCTION
  - FOR FINAL LAYOUT APPROVAL OF TRANSIT PADS PRIOR TO INSTALLATION, PLEASE CONTACT DAVID STOWE AT (905) 874-2700 EXT 62379 OR CHRIS LAFLEUR EXT 62620
  - CITY REFERS TO THE CITY OF BRAMPTON
  - SEE DRAWINGS - - - FOR DIMENSIONS
  - SEE DRAWINGS - - - FOR REMOVALS
  - SEE DRAWING - - - FOR TYPICAL CROSS SECTIONS
  - SEE DRAWINGS - - - FOR PAVEMENT ELEVATION DETAILS
  - SEE DRAWINGS - - - FOR PAVEMENT MARKINGS AND SIGNAGE
  - SEE DRAWINGS - - - FOR LANDSCAPING DRAWINGS
  - SEE DRAWINGS - - - FOR STRUCTURAL DRAWINGS
- REFERENCE:** BENCH MARK F2-581 240.393m  
One story brick building, no 43 Regan Road. Table is set in the southeast face of concrete foundation, 3.25m northeasterly of the southerly building corner and 0.15m above the sidewalk.

Scale: 60m, 50m, 40m, 30m, 20m, 10m, 0m, 5m, 10m

NO.	BY	DATE	REVISIONS	CHECKED
01	M.K.	15NOV19	ISSUED FOR 30% REVIEW	M.K.

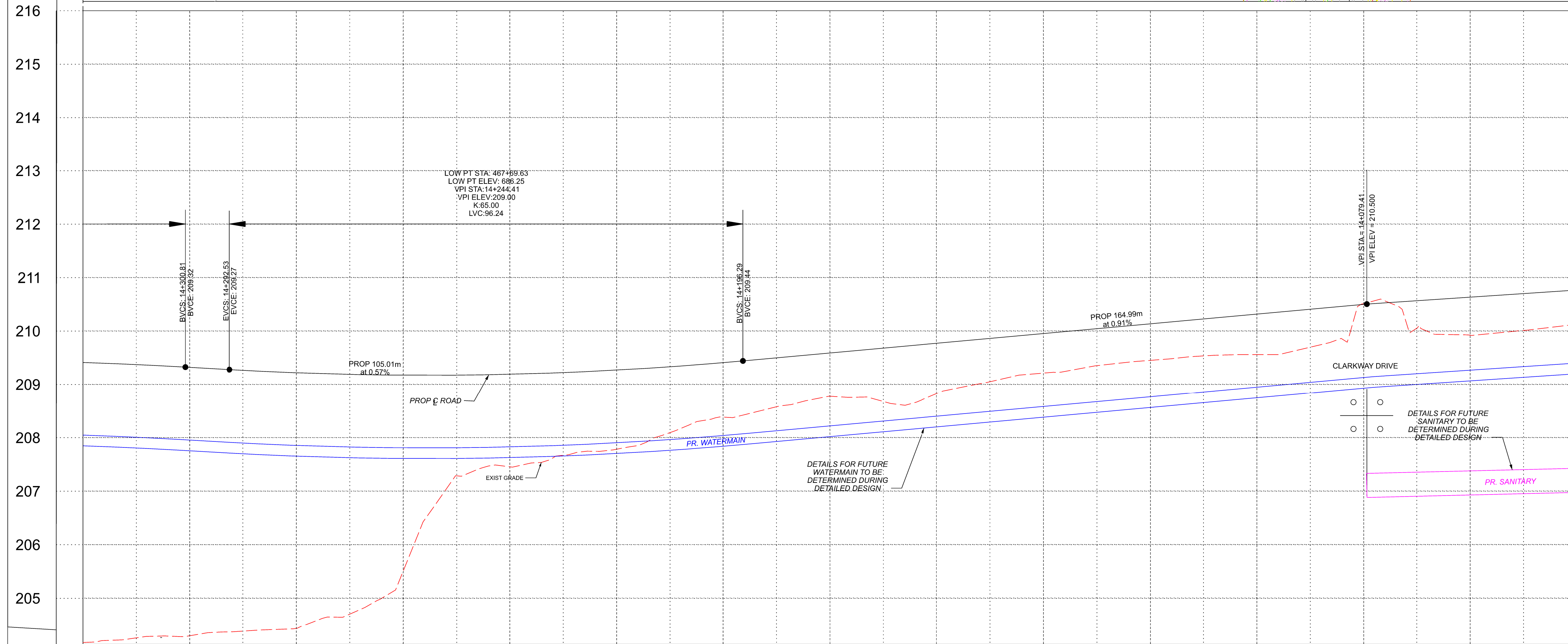

STORM INVERT	SANITARY INVERT	PROPOSED GRADES	CENTERLINE CHAINAGE
		14+320 209.41	14+320
		14+300 209.32	14+300
		14+280 209.22	14+280
		14+260 209.17	14+260
		14+240 209.19	14+240
		14+220 209.27	14+220
		14+200 209.40	14+200
		14+180 209.59	14+180
		14+160 209.77	14+160
		14+140 209.95	14+140
		14+120 210.13	14+120
		14+100 210.31	14+100
		14+080 210.49	14+080
		14+060 210.63	14+060
		14+040 210.76	14+040

**BRAMPTON** Flower City  
**Region of Peel** working with you

**Public Works & Engineering**  
**Capital Works**

**wood.**

PROJECT	DWG. NO.
---------	----------

**EAST WEST**  
**STA. 14+320 TO STA. 14+040**  
Description

**PROPOSED RECONSTRUCTION**

SURVEYED BY: BRAMPTON	DATE: NOVEMBER 15, 2019	FILE NO.	xxxxxx
DRAWN BY: A. KARAMBAKHSHAN	CHECKED BY: M. KHAN	DRAWING NO.	
DESIGNED BY: M. KHAN	CHECKED BY: M. KHAN		
SCALE: v 1:50 h 1:500	DATE: 15 NOV 19		<b>XX-XX-XX</b>







**FOR STORM AND ROADWORKS ONLY**

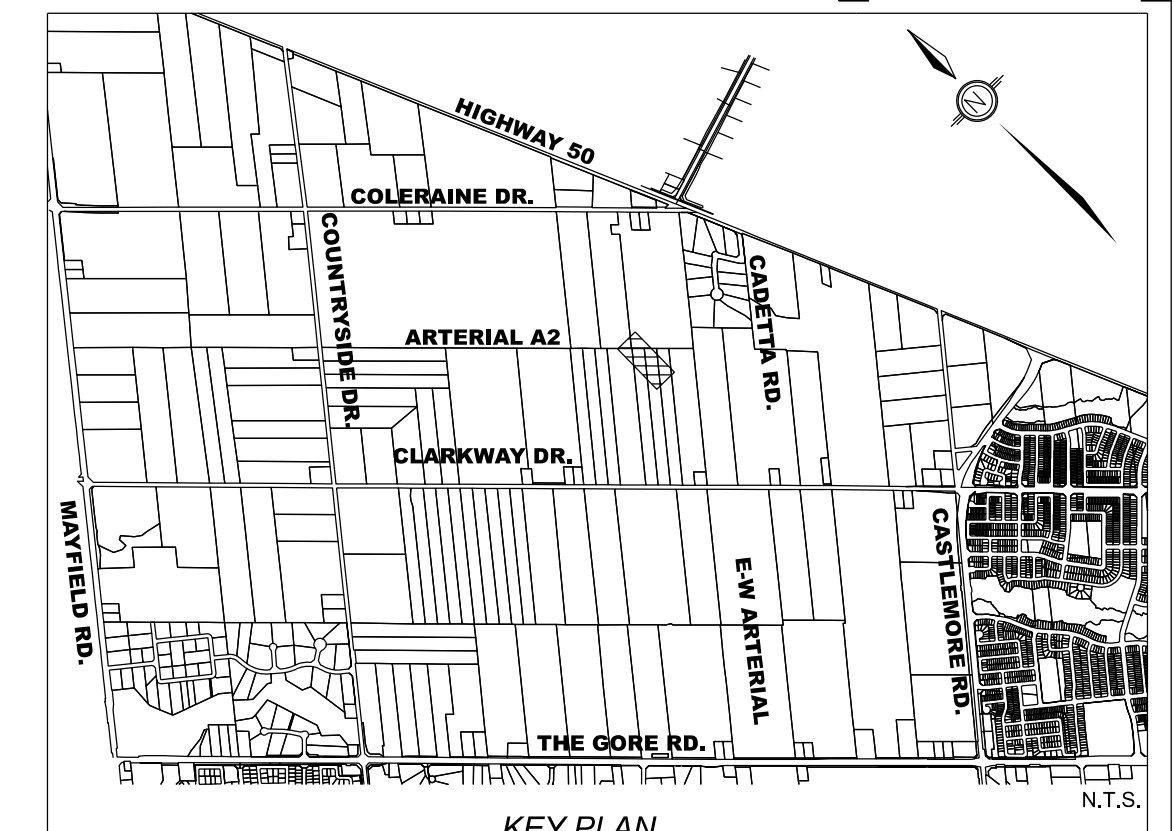

**EAST WEST ARTERIAL**

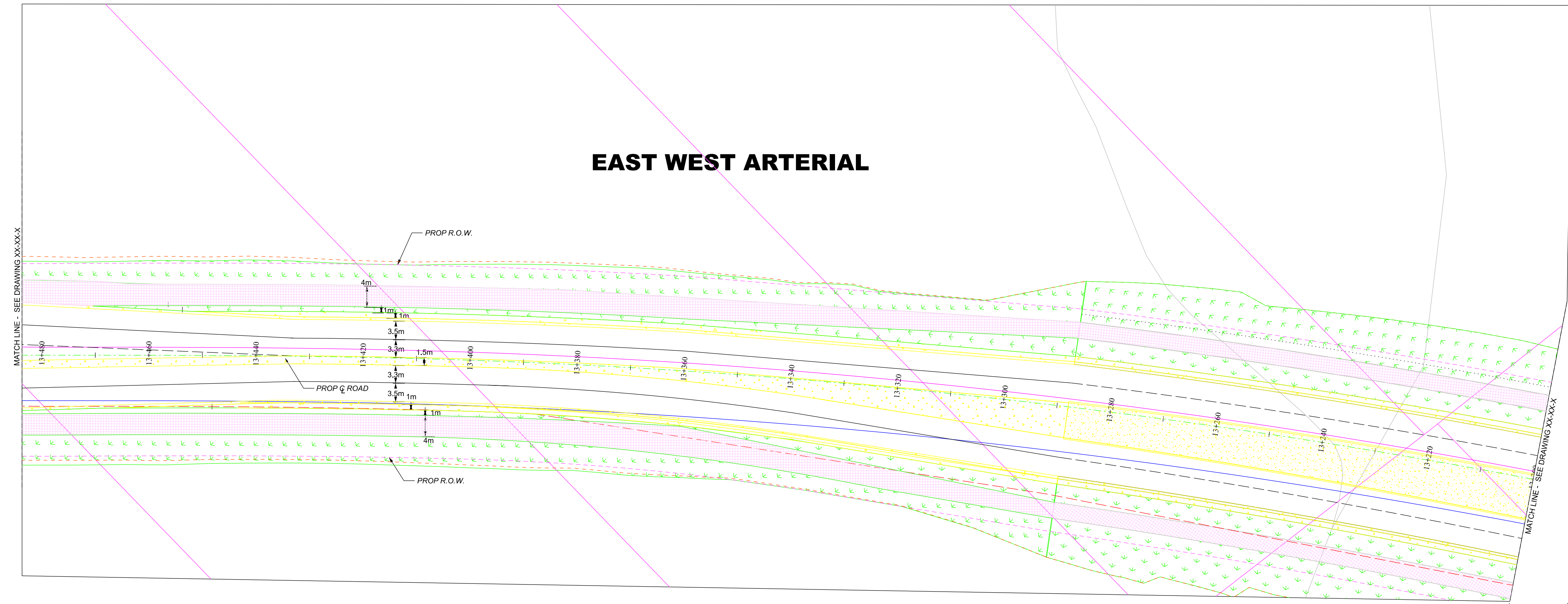

**LEGEND:**

PROP CONC BUS BAY	PROP SEED / SOD
PROP CONC KILLSTRIP/MEDIAN	PROP IMPRESSED COLOURED CONC
PROP ASPHALT PAVEMENT	PROP ASPH MULTI USE TRAIL
PROP DW REINSTATEMENT	PROP DW RELOCATED / NEW
PROP STORM SEWER (PROFILE ONLY)	PROP TEMP ASPH PEDESTRIAN CONNECTION
PROP MILLING & PLACEMENT OF 40mm H1	PROP SILT FENCE (TREE HOARDINGS)
PROP CONC SIDEWALK / BUS PAD	PROP LIMIT OF GRADING
PROP TACTILE WALKING STRIP INDICATOR	PROP TEMP ROCK CHECK DAM [DPSD 219.210]
EX SANITARY SEWER	EX OVERHEAD HYDRO
EX WATERMAIN	EX BELL
EX GAS	PROP OVERHEAD HYDRO
PROP WATERMAIN	PROP UNDERGROUND HYDRO
PROP SANITARY SEWER	PROP STORM SEWER

**NOTES:**

- ALL EXIST MH TOPS, GAS, WATER & OTHER APPURTENANCES TO BE ADJUSTED TO SUIT PROP GRADES
- DCB & DICB LEADS TO BE 200mm, CB LEADS TO BE 200mm, UNLESS OTHERWISE NOTED
- ALL EXISTING CURBS WITHIN P.O.W. TO BE REMOVED UNLESS OTHERWISE NOTED
- PROPOSED MEDIANS TO HAVE CONCRETE BARRIER CURB O.P.S.D. 600.080
- PROPOSED CONCRETE KILLSTRIP / MEDIAN SHALL BE DESIGNED TO 150mm CONCRETE 32MPa 200mm OF 20mm CRUSHER RUN LIMESTONE
- ALL EXISTING UTILITY LOCATIONS ARE APPROXIMATE AND ARE TO BE CONFIRMED IN THE FIELD PRIOR TO CONSTRUCTION
- FOR FINAL LAYOUT APPROVAL OF TRANSIT PADS PRIOR TO INSTALLATION, PLEASE CONTACT DAVID STOWE AT (905) 874-2750 EXT 62379 OR CHRIS LAFLEUR EXT 62620
- CITY REFERS TO THE CITY OF BRAMPTON
- SEE DRAWINGS - - - FOR DIMENSIONS
- SEE DRAWINGS - - - FOR REMOVALS
- SEE DRAWING - - - FOR TYPICAL CROSS SECTIONS
- SEE DRAWINGS - - - FOR PAVEMENT ELEVATION DETAILS
- SEE DRAWINGS - - - FOR PAVEMENT MARKINGS AND SIGNAGE
- SEE DRAWINGS - - - FOR LANDSCAPING DRAWINGS
- SEE DRAWINGS - - - FOR STRUCTURAL DRAWINGS

**REFERENCE:** BENCHMARK F2-581 240.393m  
One story brick building, no 45 Regan Road. Tablet is set in the southeast face of concrete foundation, 3.25m northeasterly of the southerly building corner and 0.15m above the sidewalk.

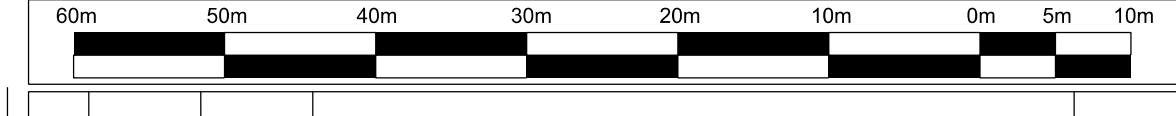

NO.	BY	DATE	REVISIONS	CHECKED
01	M.K.	15NOV19	ISSUED FOR 30% REVIEW	M.K.

**BRAMPTON** Flower City  
**Region of Peel** working with you  
**wood.**  
**Public Works & Engineering**  
**Capital Works**

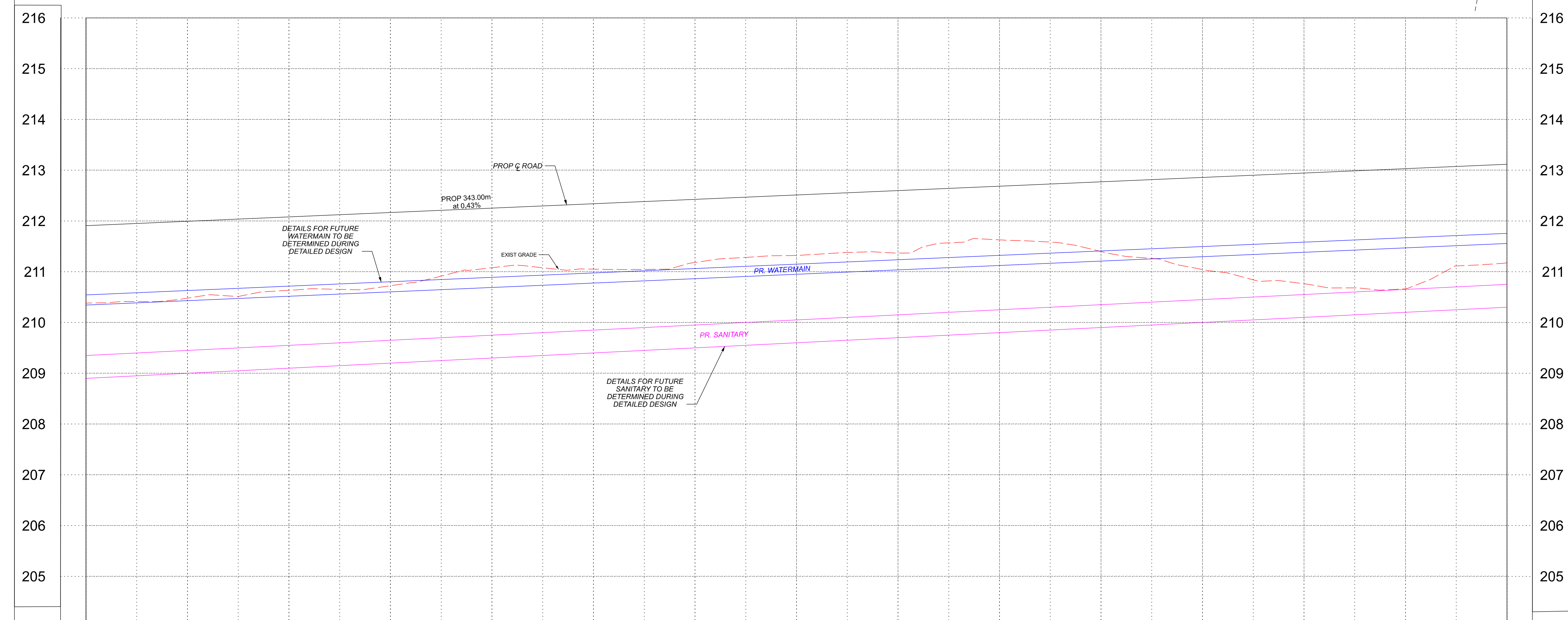

STORM INVERT	SANITARY INVERT	PROPOSED GRADES	CENTERLINE CHAINAGE	STORM INVERT	SANITARY INVERT	PROPOSED GRADES	CENTERLINE CHAINAGE
		13+480 211.85	13+480			13+200 213.25	13+200
		13+460 211.59	13+460			13+220 213.03	13+220
		13+440 212.08	13+440				
		13+420 212.17	13+420				
		13+400 212.25	13+400				
		13+380 212.34	13+380				
		13+360 212.42	13+360				
		13+340 212.51	13+340				
		13+320 212.60	13+320				
		13+300 212.68	13+300				
		13+280 212.77	13+280				
		13+260 212.86	13+260				
		13+240 212.94	13+240				
		13+220 213.03	13+220				

**EAST WEST**  
**STA. 13+480 TO STA. 13+200**  
 Description  
**PROPOSED RECONSTRUCTION**

SURVEYED BY: BRAMPTON	DATE: NOVEMBER 15, 2019	FILE NO.	xxxxxx
DRAWN BY: A. KARAMBAKSHIAN	CHECKED BY: M. KHAN	DRAWING NO.	
DESIGNED BY: M. KHAN	CHECKED BY: M. KHAN		
SCALE: v 1:50 h 1:500	DATE: 15 NOV 19	<b>XX-XX-XX</b>	<b>X</b>