

TYPICAL WATERPROOFING DETAILS FOR ABOVE AND BELOW GRADE MAINTENANCE HOLE TOP SECTIONS

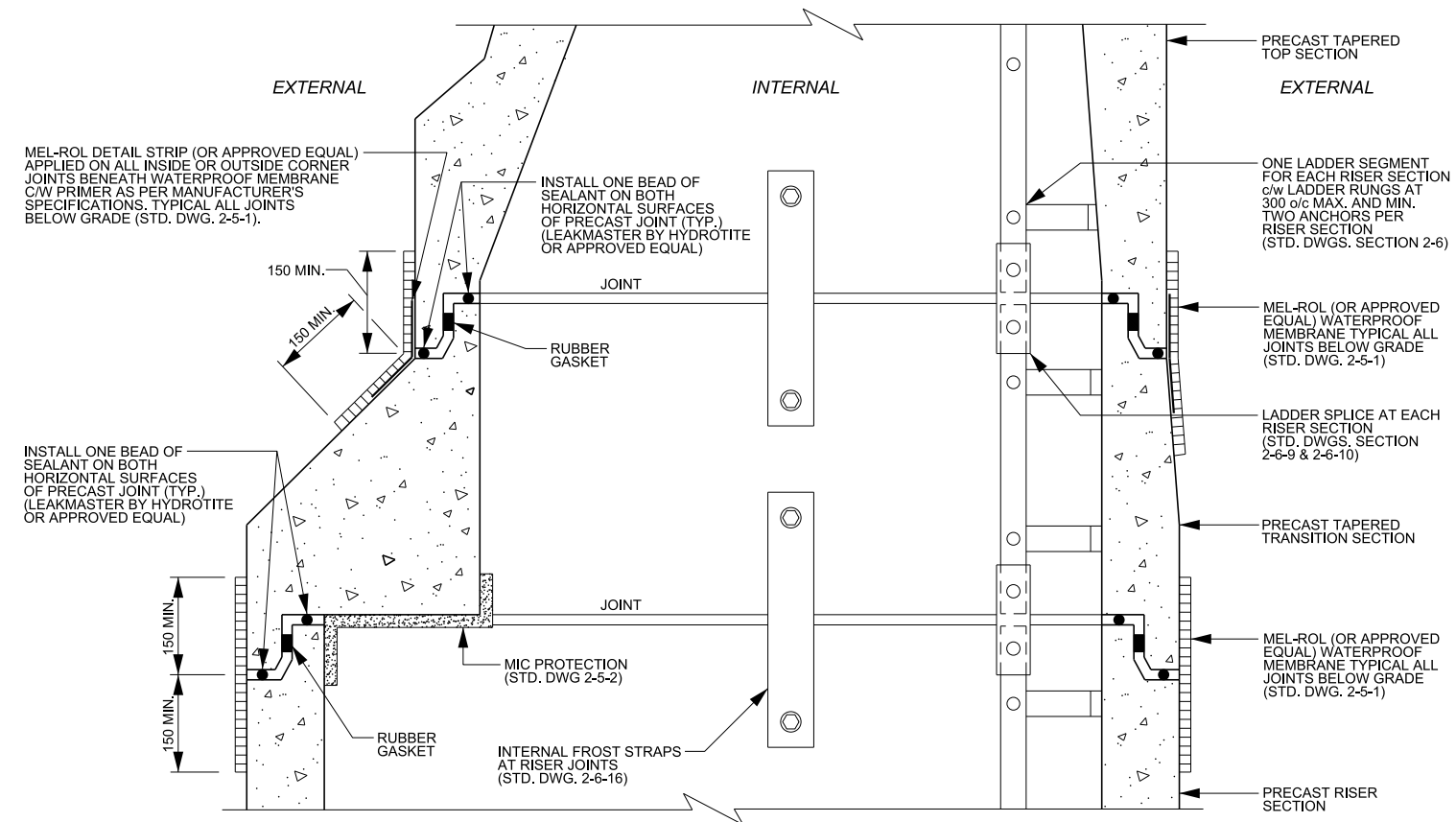

TYPICAL WATERPROOFING DETAILS FOR BELOW GRADE MAINTENANCE HOLE JOINTS

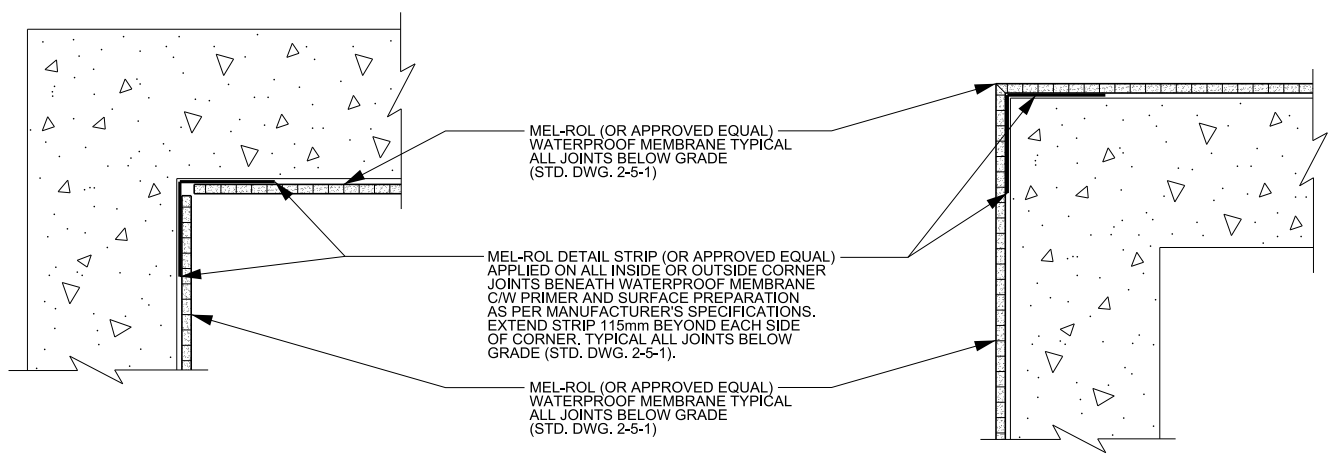

TYPICAL INSIDE CORNER WATERPROOFING DETAILS

TYPICAL OUTSIDE CORNER WATERPROOFING DETAILS

- NOTE**
1. REFER TO STANDARD DRAWING 2-5-1 FOR GENERAL NOTES PERTAINING TO PRECAST MAINTENANCE HOLES.
 2. REFER TO STANDARD DRAWING 2-5-2, 2-5-9 FOR TYPICAL INSTALLATION OPTIONS AND REQUIREMENTS.
 3. ANGLED OR TAPERED ADJUSTMENT UNITS (COMPOSITE) TO BE USED AT TOP OF ADJUSTMENT UNIT SECTION TO MEET FINAL GRADE REQUIREMENTS. USE OF SHIMS IS NOT PERMITTED TO MEET FINAL GRADE REQUIREMENTS.
 4. MINIMUM 150mm PRECAST ADJUSTMENT RING UNIT TO BE USED IF MECHANICAL ANCHORING OF FRAME TO BE PERFORMED. COMPOSITE GRADE RINGS TO BE UTILIZED FOR ADJUSTMENTS UNDER 150mm AS REQUIRED (CRETEX PRO-RING OR APPROVED EQUAL).

NEW CONSTRUCTION		REHABILITATION	
FULL EXCAVATION	PARTIAL EXCAVATION	NO EXCAVATION	
INTERNAL		EXTERNAL	
ROW	FLOOD PLAIN	EASEMENT	
I/I	H2S	SECURITY	

	PUBLIC WORKS STANDARD DRAWING		REV. DATE: NOVEMBER 2019
	NEW SANITARY SEWER CONSTRUCTION		REVISION NUMBER: 1 FOR REVISION TRACKING REFER TO STD. DWG. 2-0-2
WATERPROOFING DETAILS			APPROVED BY: _____ DRAWN BY: _____ A.P. _____ AINLEY GROUP
			STD. DWG. NUMBER: _____ SCALE: _____ 2-5-25 N.T.S.